

## CELLBAG10L/P Disposable Bioreactor Chamber

The *Cellbag*<sup>®</sup> 10L/P is a disposable bioreactor designed for use with the SYSTEM20/50 *Wave Bioreactor*<sup>®</sup> configured with a KIT20. The part number CELLBAG10L/P indicates a perfusion-ready bag. These bioreactor chambers are provided sterile by gamma radiation and are to be discarded after single use. No sterilization or cleaning is required. The cell contact surface is FDA approved low density polyethylene of the type routinely used for blood collection and handling of biological fluids. Outer layers are made of proprietary composites that provide exceptional strength and extremely low gas permeability. Each *Cellbag* includes the following fittings: 1) Clog-resistant inlet air and vent filters; 2) a Clave<sup>®</sup> needleless syringe sampling connector; 3) a length of 1/8inch ID C-Flex<sup>®</sup> tubing for tube fuser connection terminated with a luer. All fittings are sterilized with the bag.

**NOTE: Do Not Fold Product in Storage**  
Photo of 2L size shown as example

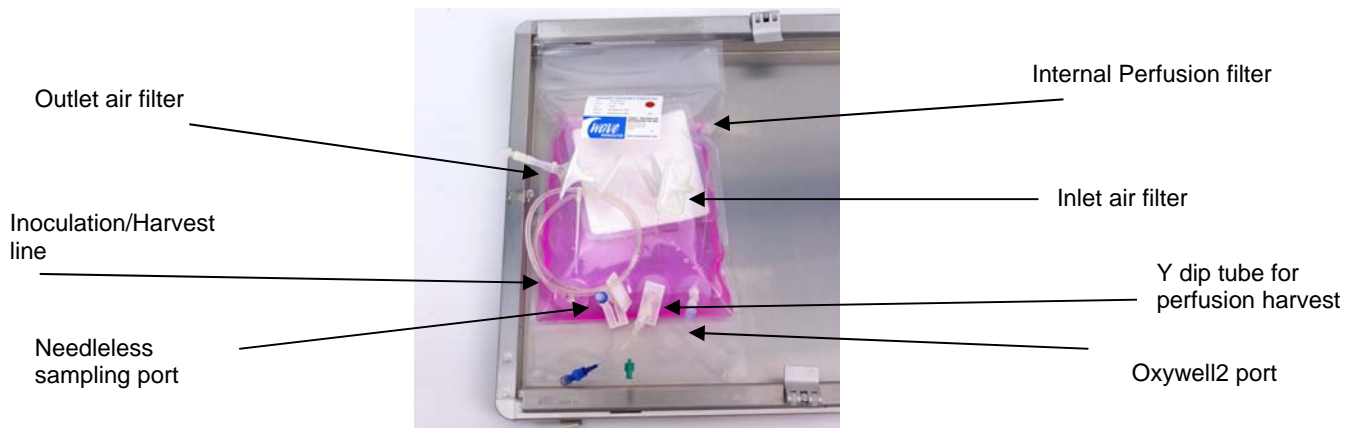

### Performance:

All plastic components conform to USP Class VI  
Each *Cellbag* lot is LAL tested and released  
Contact layer is LDPE with no leachables  
Sterilized by gamma radiation to 25-40kGy  
Individually pressure tested

### Fittings included:

One Inlet air filter bidirectional hydrophobic 0.2 micron gas filter.  
One Outlet vent filter bidirectional hydrophobic 0.2 micron gas filter with check valve.  
One Clave sampling connector; use standard syringe (no needle).  
One Oxywell2™ port for dissolved oxygen probe insertion.  
One C-Flex 1/8" ID, 1/4" OD tubing terminated with luer and cap, 39 inch length for fusing.  
Internal perfusion filter device with external Clave connection for sampling and female luer connection for harvest.

### Operation:

Minimum culture volume: 0.5 liter  
Maximum culture volume: 5 liter